

MITCHELL

AT300.AT300W

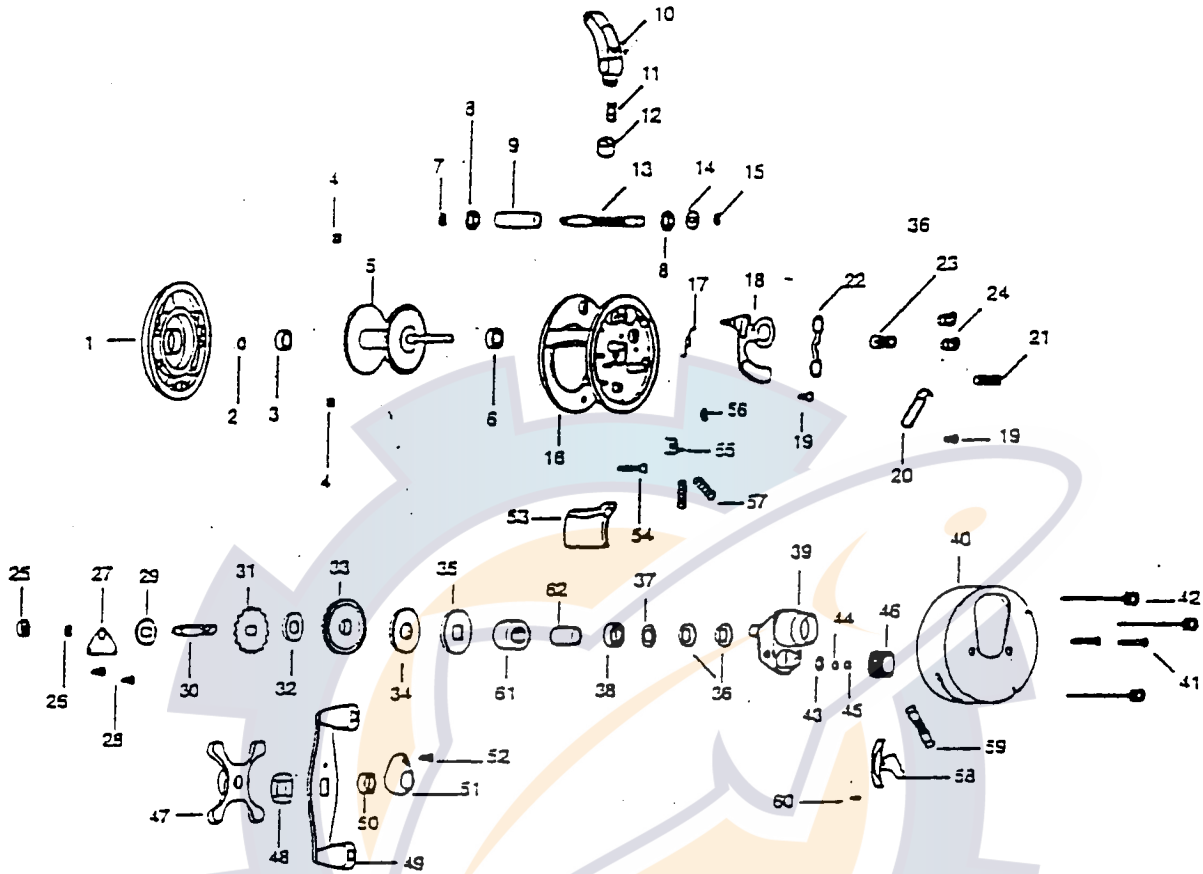

ITM.	AT300	AT300W	DESCRIPTION	ITM.	AT300	AT300W	DESCRIPTION
1	888-3628		LEFT SIDE COVER ASSEMBLY	33	888-3725		DRIVE GEAR
2	888-3629		SPOOL TENSION SHIM	34	888-3725		DRAG DISC WASHER
3	888-3630		BALL BEARING	35	888-3727		DRAG WASHER
4	888-3631		BRAKE SHOE	36	888-3729		SPRING "D" WASHER
5	888-3632	888-3633	SPOOL ASSEMBLY	37	888-3729		BEARING WASHER
6	888-3634		BALL BEARING	38	888-3730		BALL BEARING
7	888-3635		E-CLIP	39	888-3731		RIGHT HOLDER
8	888-3636		WORM SHAFT BUSHING	40	888-3732		RIGHT SIDE COVER
9	888-3637	888-3638	CARRIER GUIDE	41	888-3733		RIGHT SIDE COVER SCREW
10	888-3639		CARRIER ASSEMBLY	42	888-3734	888-3735	THUMB SCREW
11	888-3700		LINE GUIDE PAWL	43	888-3736		TENSION KNOB O-RING
12	888-3701		PAWL CAP	44	888-3737		TENSION KNOB WASHER
13	888-3702	888-3703	WORM SHAFT	45	888-3738		TENSION KNOB SHIM
14	888-3704		OSCILLATING GEAR	46	888-3739		TENSION KNOB
15	888-3705		E-CLIP	47	888-3740		STAR DRAG
16	888-3706	888-3707	FRAME	48	888-3741		HANDLE SPRING WASHER
17	888-3708		RELEASE SLIDER SPRING	49	888-3742		HANDLE ASSEMBLY
18	888-3709		RELEASE SLIDER	50	888-3743		HANDLE NUT
19	888-3710		RELEASE SLIDER SCREW	51	888-3744		HANDLE NUT LOCK CAP
20	888-3711		KICK LEVER	52	888-3745		HANDLE NUT LOCK SCREW
21	888-3712		KICK LEVER SPRING	53	888-3746	888-3747	THUMB BAR
22	888-3713		PINION YOKE	54		888-3748	CLICKER SHAFT
23	888-3714		PINION ASSEMBLY	55		888-3749	CLICKER
24	888-3715		YOKE SPRING	56		888-3750	E-CLIP
25	888-3716		CRANK SHAFT BUSH	57		888-3751	CLICK SPRING
26	888-3717		E-CLIP	58		888-3752	SOUND LEVER
27	888-3718		CRANK SHAFT RETAINER	59		888-3753	SOUND LEVER SPRING
28	888-3719		CRANK SHAFT RETAINER SCREW	60		888-3754	SOUND LEVER PIN
29	888-3720		IDLE GEAR	61	888-3755		ONE WAY CLUTCH BALL BEARING
30	888-3721	888-3722	CRANK SHAFT	62	888-3756		ONE WAY CLUTCH BALL BEARING BUSH
31	888-3723		RATCHET				
32	888-3724		DRIVE GEAR WASHER				